

## Project Update

### Canterbury Hospital Redevelopment

August 2025



Redevelopment project team at hospital foyer pop-ups

The NSW Government is investing \$350 million in the Canterbury Hospital Redevelopment to expand the facility and deliver upgrades to existing infrastructure. It will be the biggest upgrade to the hospital in more than 26 years, providing patients and staff with access to the latest facilities.

The project team finalised the concept design in June 2025. During this stage we engaged extensively with staff and the community, online and in person, to gather valuable feedback that has helped shape the future Canterbury Hospital. See what we heard, and how the feedback helped shape the design, in our Concept Design Outcomes Report, available on the project website.

## Schematic design

We have now progressed into the schematic design stage, which takes the design of the building and its services to the next level of detail. This phase focuses on developing department-specific designs, mapping out the location and function of each space, and optimising workflow and patient movements to create an efficient, patient-centred hospital.

## Concept design outcomes report

Thank you to everyone who shared feedback on the concept design for the Canterbury Hospital Redevelopment. Your input is helping shape a hospital that reflects the needs and priorities of the community.



The Concept Design Outcomes Report summarises what we heard during consultation and is now available on the project website at [www.haveyoursay.nsw.gov.au/download\\_file/view/9958/1610](https://www.haveyoursay.nsw.gov.au/download_file/view/9958/1610) or scan the QR code.

Throughout August 2025, we held a series of design engagement sessions with staff and key stakeholders to review the schematic design plans and ensure the future hospital spaces are functional and fit for purpose.

Schematic design is the next stage in hospital planning, where the concept design evolves into more detailed layouts. At this point, the focus shifts from the overall vision to the finer detail of how spaces and services will work together within each department.

During this stage, architects and planners collaborate closely with clinicians and stakeholders to ensure that layouts support safe and efficient care. The aim is to create hospital spaces that are practical for staff, welcoming for patients and visitors, and ready to meet future healthcare needs.

Once schematic design is complete, the project will move into the detailed design stage, where each design element will be finalised. Learn more in our Schematic Design Fact Sheet and Frequently Asked Questions at [www.haveyoursay.nsw.gov.au/canterbury-hospital-redevelopment](http://www.haveyoursay.nsw.gov.au/canterbury-hospital-redevelopment)

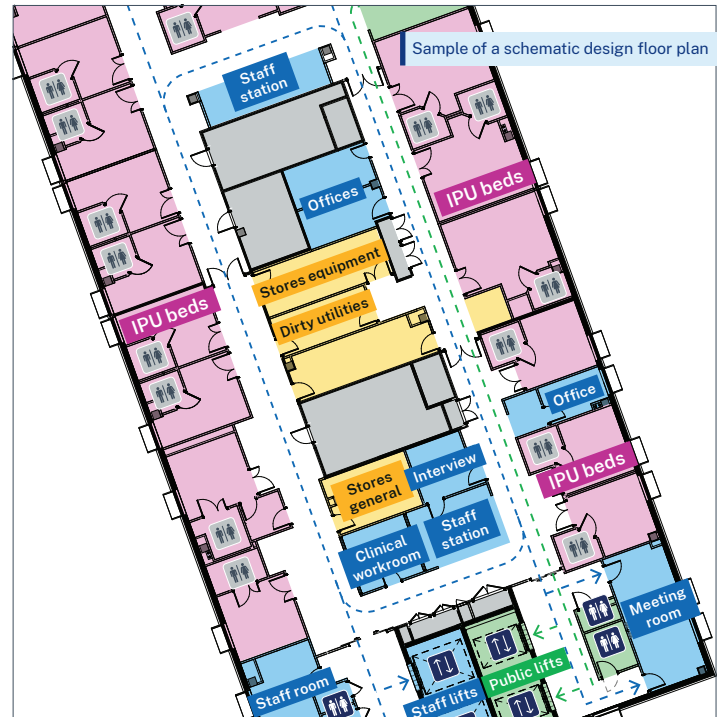

## We are going paperlite!



The Canterbury Hospital Redevelopment is transitioning to digital newsletters as part of our commitment to be more sustainable. Some of our newsletters will be printed and delivered but the majority will be distributed via our online database.

To stay informed and receive updates straight to your inbox, subscribe to our project updates at [greenarrow.health.nsw.gov.au/ga/front/forms/160/subscriptions/new/](http://greenarrow.health.nsw.gov.au/ga/front/forms/160/subscriptions/new/)

## Recent and upcoming community engagement

### Canterbury Bankstown Multicultural Interagency

The Canterbury Hospital Redevelopment team presented at the Canterbury Bankstown Multicultural Interagency (CBMIA) meeting in August 2025, alongside the New Bankstown Hospital team. The meeting provided an opportunity to share a project update, outline the next steps in the planning and design process, and strengthen connections with this important community group.

The project team will continue to work closely with CBMIA and explore further joint consultation opportunities with the New Bankstown Hospital project team as part of an integrated approach to local health facility planning. You can find out more about the New Bankstown Hospital project by visiting [nsw.gov.au/newbankstownhospital](http://nsw.gov.au/newbankstownhospital)



If you are part of a community group that would benefit from a project update from the redevelopment team, please reach out via [canterburyhospitalredev@health.nsw.gov.au](mailto:canterburyhospitalredev@health.nsw.gov.au)



## In language community pop-ups

The project team recently held a series of community pop-up sessions designed to connect with Canterbury's culturally and linguistically diverse (CALD) community. The events, held at Jubilee Reserve in Lakemba and Anzac Mall in Campsie, provided a welcoming space for residents to learn about the redevelopment, ask questions, and share feedback in their preferred language.

With support from dedicated Cultural Support Officers, information was shared in Bangla, Urdu, Arabic, Mandarin, Cantonese, Greek, and Korean, ensuring the diverse communities had access to information, while feeling heard and included. Translated project materials and in-person language support allowed people to learn about the redevelopment and engage in conversations about the hospital's future.

The response from the community was overwhelmingly positive. Residents expressed excitement about the upgrades and appreciation for the opportunity to speak



Cultural Support Officers at Campsie community pop-ups

directly with the project team. These sessions are an important step in fostering meaningful connections with the local community and ensuring people feel informed as the project progresses.

The project team would like to thank everyone who attended and our Cultural Support Officers who made the sessions a success.

## Committed to consultation

Consultation with a wide range of stakeholders and the community is essential for the planning, design and delivery of a hospital redevelopment. Early collaboration with hospital staff, management and other key stakeholders ensures the redevelopment can address specific staff and community needs and preferences.

The community is invited to learn about the project and share your views and ideas with the project team on our engagement platform called 'Have Your Say'. The platform fosters a transparent and inclusive dialogue with the project team, empowering people to contribute to the future of their hospital and healthcare services.

Explore 'Have Your Say' at [www.haveyoursay.nsw.gov.au/canterbury-hospital-redevelopment](http://www.haveyoursay.nsw.gov.au/canterbury-hospital-redevelopment)



Greek Cultural Support Officer speaking with community member

## Planning approval engagement process

As part of the planning process, the Canterbury Hospital Redevelopment will be assessed and approved via a Review of Environmental Factors (REF) under the *Environmental Planning and Assessment Act 1979 (EPA&A Act)*.

This process requires NSW Health to thoroughly assess how the project may affect the environment. It also involves extensive consultation with local communities, councils and other stakeholders during the planning and design stages.

The project will be delivered under a two-part planning approval process; one for early works and

one for main works. Each planning approval requires a separate Review of Environmental Factors (REF) submission, which will go on public exhibition for 28 days, allowing staff and the community to review and provide feedback.

The project's early works planning application is anticipated to be submitted in late 2025. The process will be supported by a range of public consultation and pop-up sessions, providing further opportunities to engage with the project team and ask questions.

The project's planning application for main works is expected to be submitted in 2026.

## Project scope

In response to the Clinical Services Plan, the redevelopment will deliver new and increased health services and facilities, including:



A new expanded and enhanced Intensive Care Unit



New purpose-built adult in-patient accommodation



Expanded and enhanced Emergency Department



Additional surgical theatres



Expanded and enhanced antenatal facilities



Additional ambulatory and outpatient care capacity



New and enhanced facilities to support clinical education, workforce training and research



New Diagnostic Services Unit to support early detection, diagnosis and medical condition management



Enhancements to hospital support services, including pathology and pharmacy



Improved accessibility to the campus, including internal access, outdoor areas, landscaping and wayfinding

## Translated information

The Canterbury Hospital Redevelopment 'Have Your Say' platform features a dedicated Multicultural Hub, where key project information is available in multiple languages. Printed copies of translated project information are also available at Canterbury Hospital.

The full project website and engagement platform can also be easily translated into many other languages via the language button, in the top right hand corner of each website.

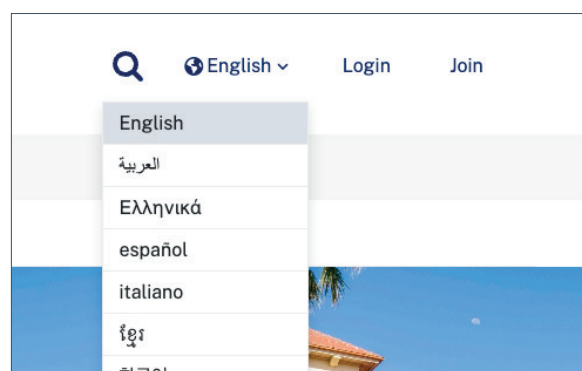

### Stay up to date

To be involved in the Canterbury Hospital Redevelopment or to follow the redevelopment's progress, subscribe to our project updates via the QR code below or visit [greenarrow.health.nsw.gov.au/ga/front/forms/160/subscriptions/new/](https://greenarrow.health.nsw.gov.au/ga/front/forms/160/subscriptions/new/)



For an interpreter, call **131 450** and ask them to call **02 9978 5959**

## For more information

T: 02 9978 5959

E: [CanterburyHospitalRedev@health.nsw.gov.au](mailto:CanterburyHospitalRedev@health.nsw.gov.au)

W: [nsw.gov.au/canterbury-hospital-redevelopment](https://nsw.gov.au/canterbury-hospital-redevelopment)